



WWW.BARRYIND.COM

RZC2010CB-XXXXJN-99

BeO

TERMINATION

Features:

- ◆ BeO
- ◆ Surface Mountable
- ◆ 30 Watt input power
- ◆ DC - 1 GHz

General Description:

The RZC2010CB-XXXX*JN-99 is a surface mountable chip termination capable of an input power of 30 Watts while maintaining a constant mounting surface temperature of 100°C. It offers an excellent frequency range from DC to 1 GHz.

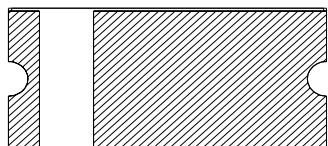
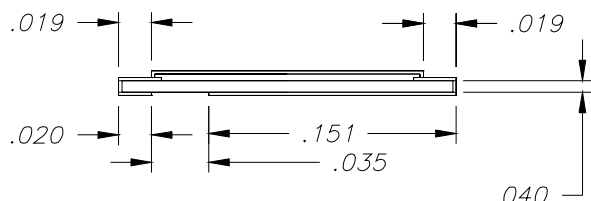
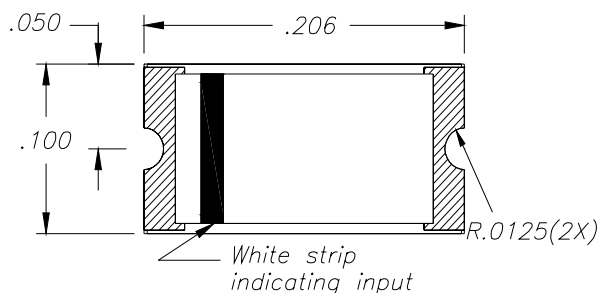

MOUNTING SURFACE
Dimensions in inches
Tolerance $\pm .010$

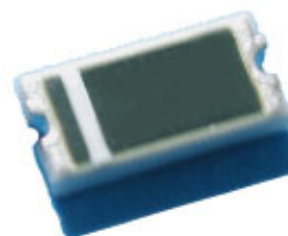

* XXXX = Resistance Value in Ohms

Ohms
0.5...R500
11R00
10.....10R0
50.....50R0
100...1000

Sample part number:
RZC2010CB-50R0JN-99

DERATING CURVE:

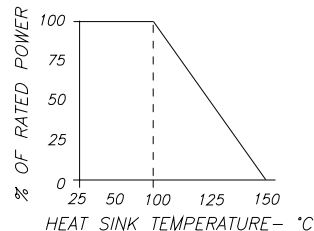

Parameter	Min.	Typ.	Max.	Units
Frequency Range	DC		1	GHz
Input Return Loss	17			dB
Input Power			30	Watts
Resistance		+/- 5%		Ohms
Mounting Surface Temperature			100	°C

Barry Industries reserves the right to change part number and or process without notification.

Barry Industries, Inc., 60 Walton St., Attleboro, MA 02703 T: 508-226-3350 F: 508-226-3317 E-mail: ABSales@Vishay.com

Barry Industries maintains an ISO 9001 Certified Quality Management System

Origination Date	Revision Date	Rev.
04/13/04	07/13/07	A